

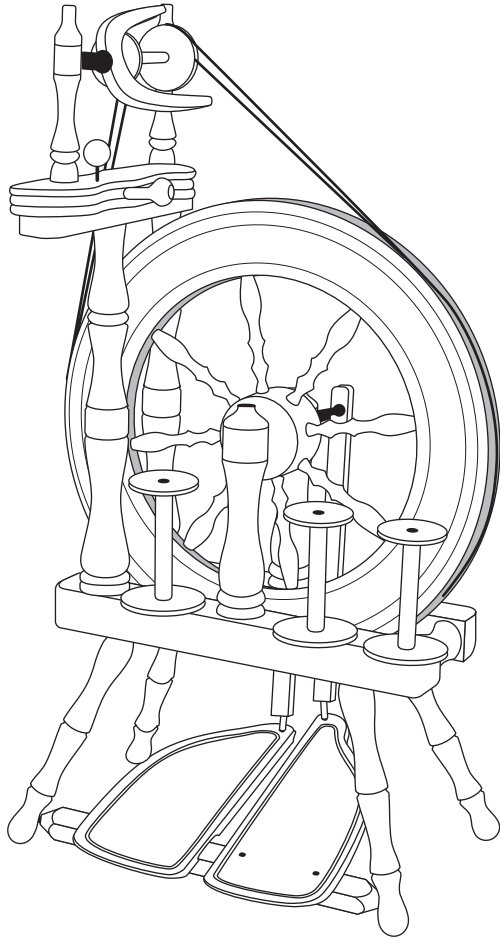

ASSEMBLY INSTRUCTIONS FOR THE ASHFORD TRAVELLER SPINNING WHEEL

- Double Drive -



TOOLS

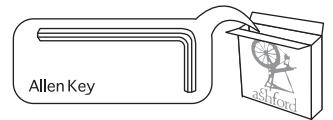
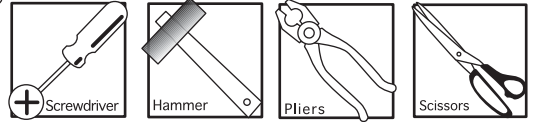

Hint 1

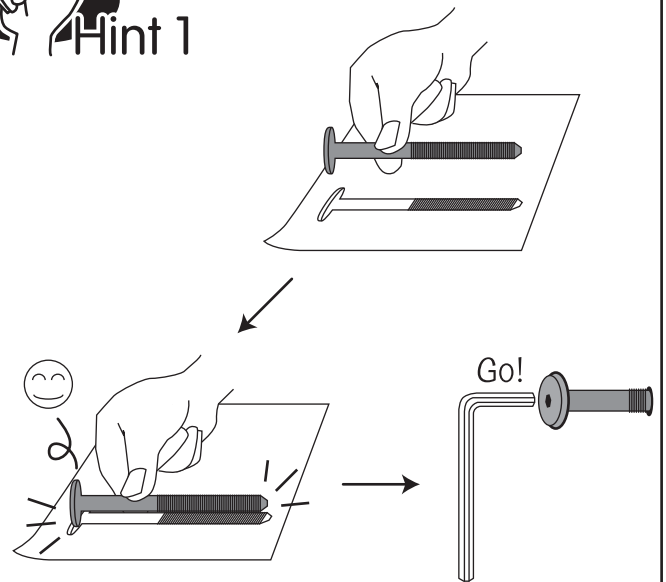

Hint 2

Hard

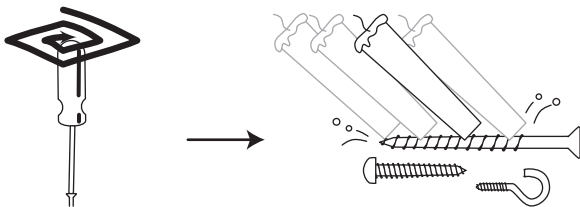

Easy

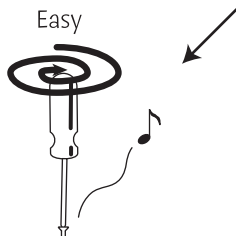

Hint 3

Hard



Easy

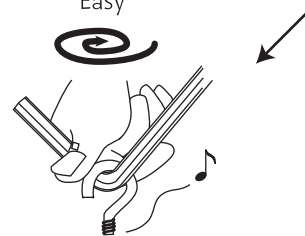

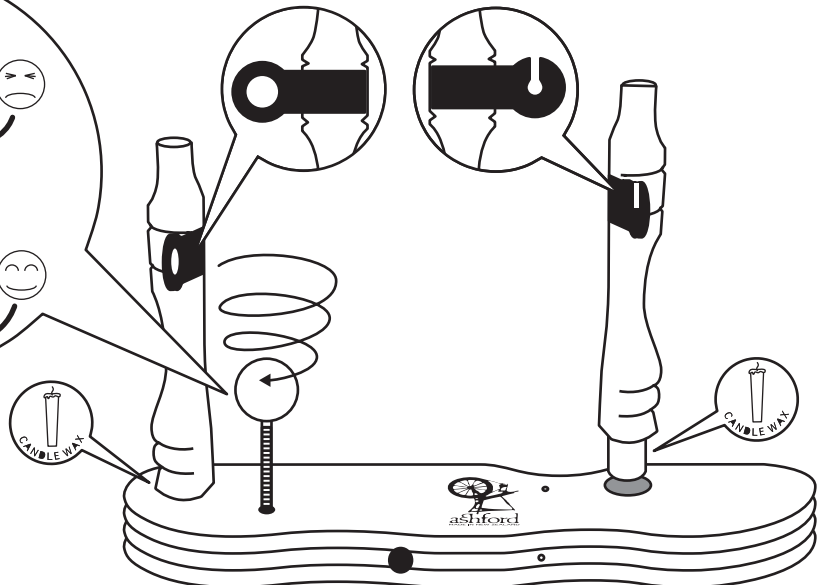
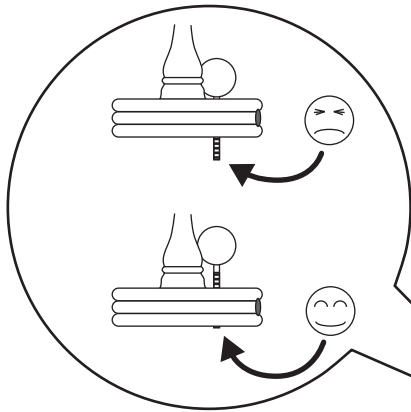
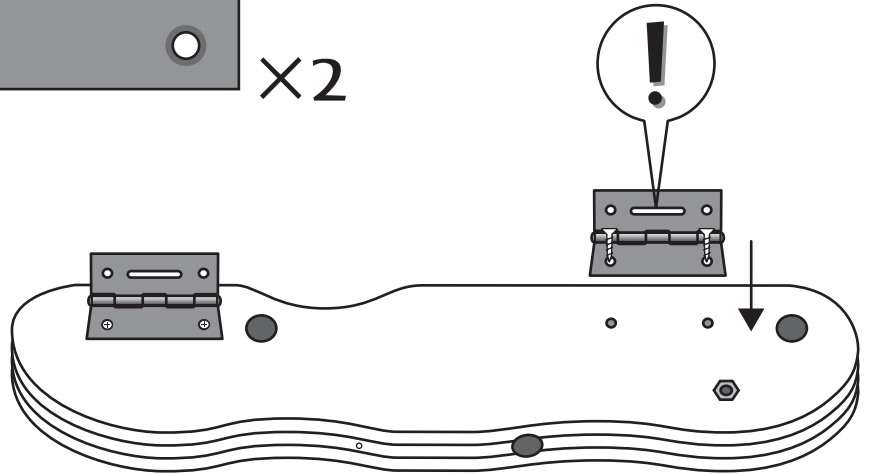
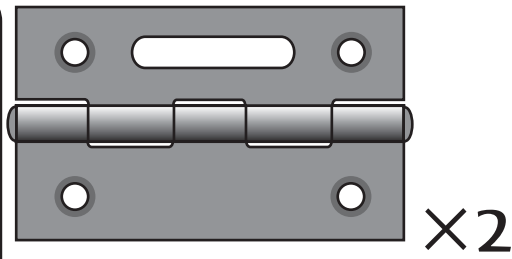
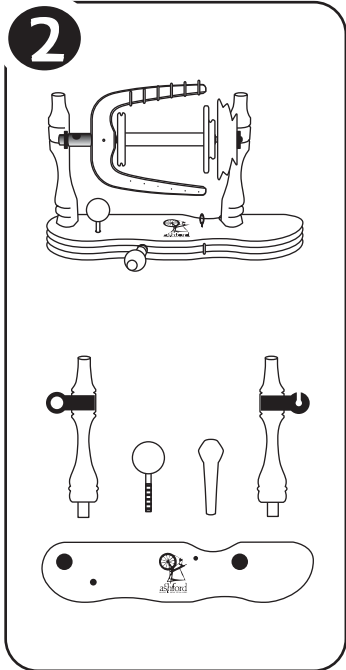
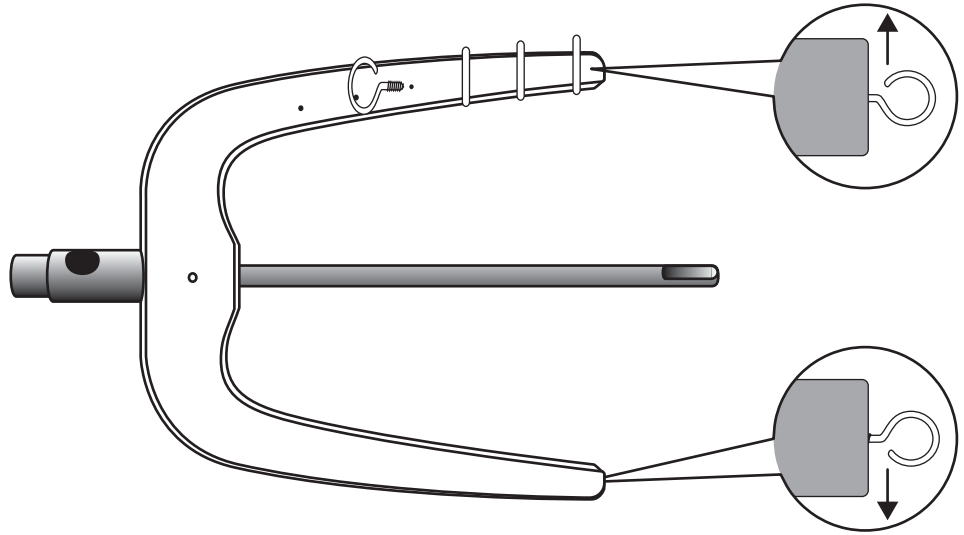
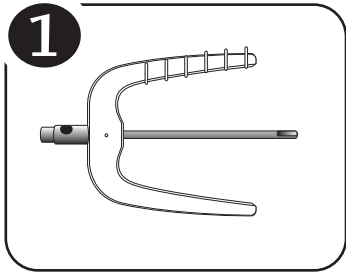

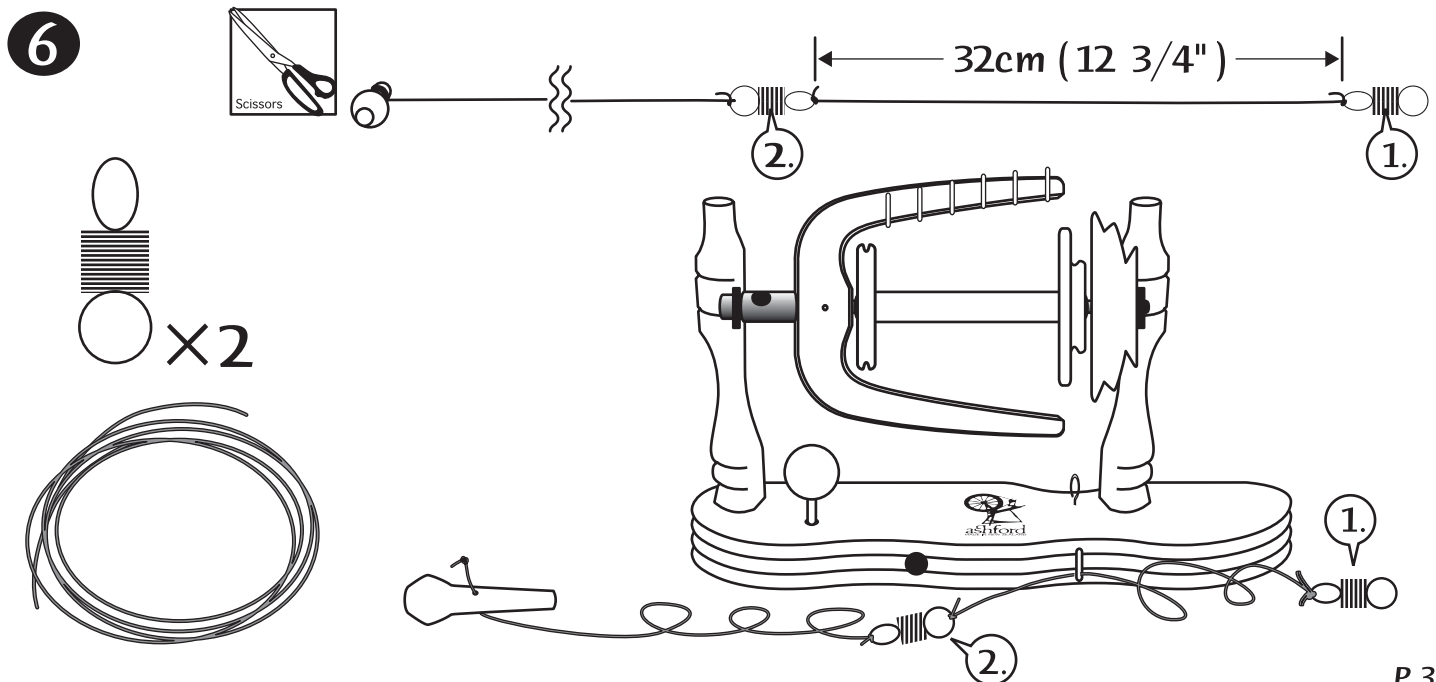
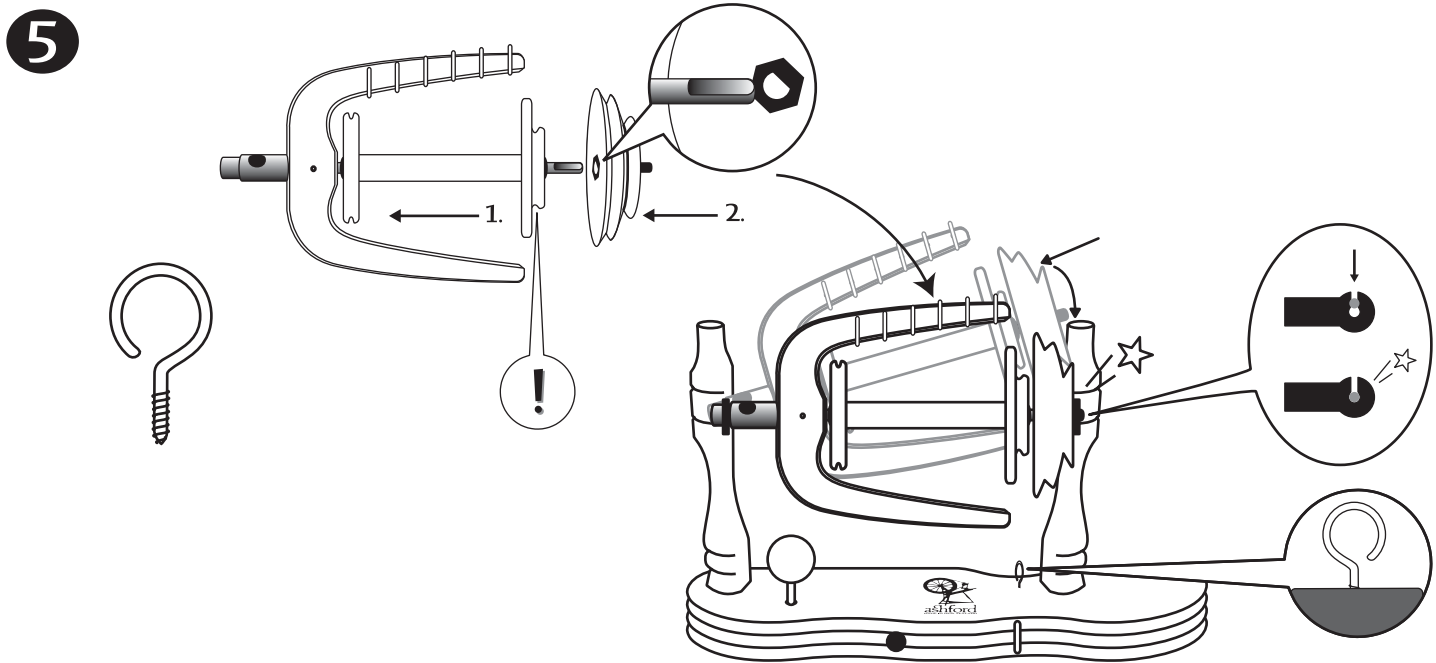
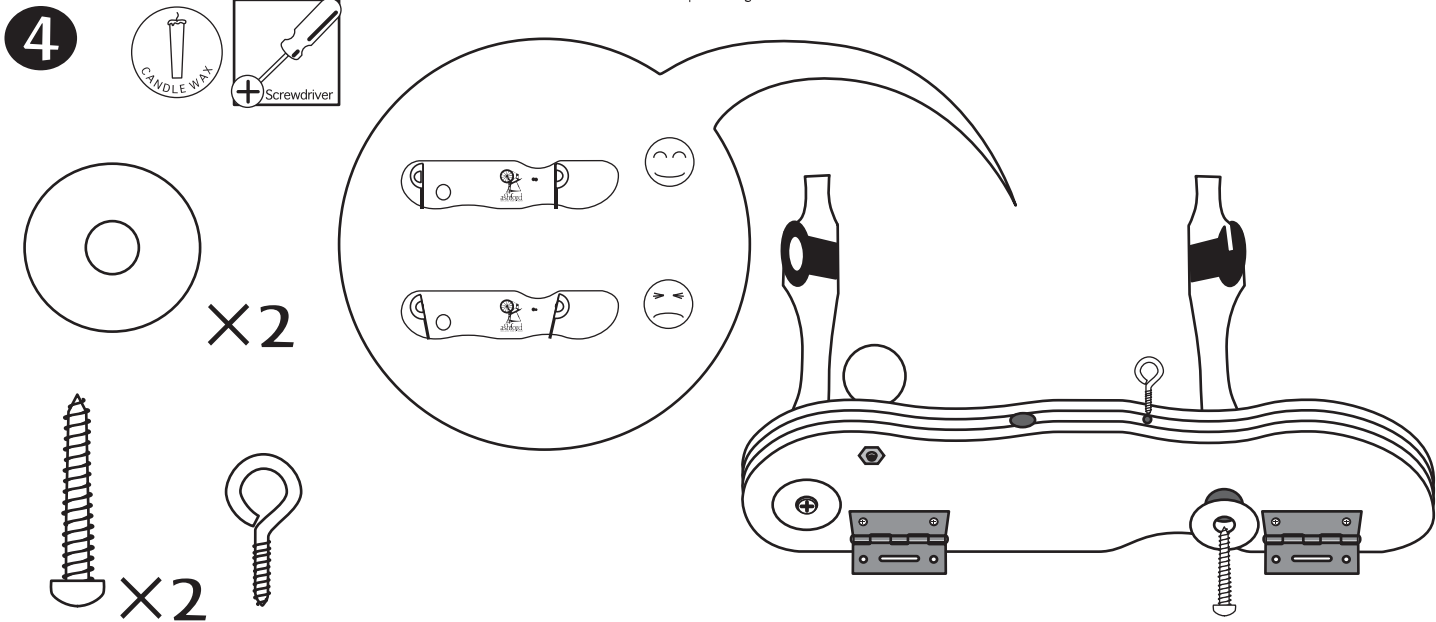

7

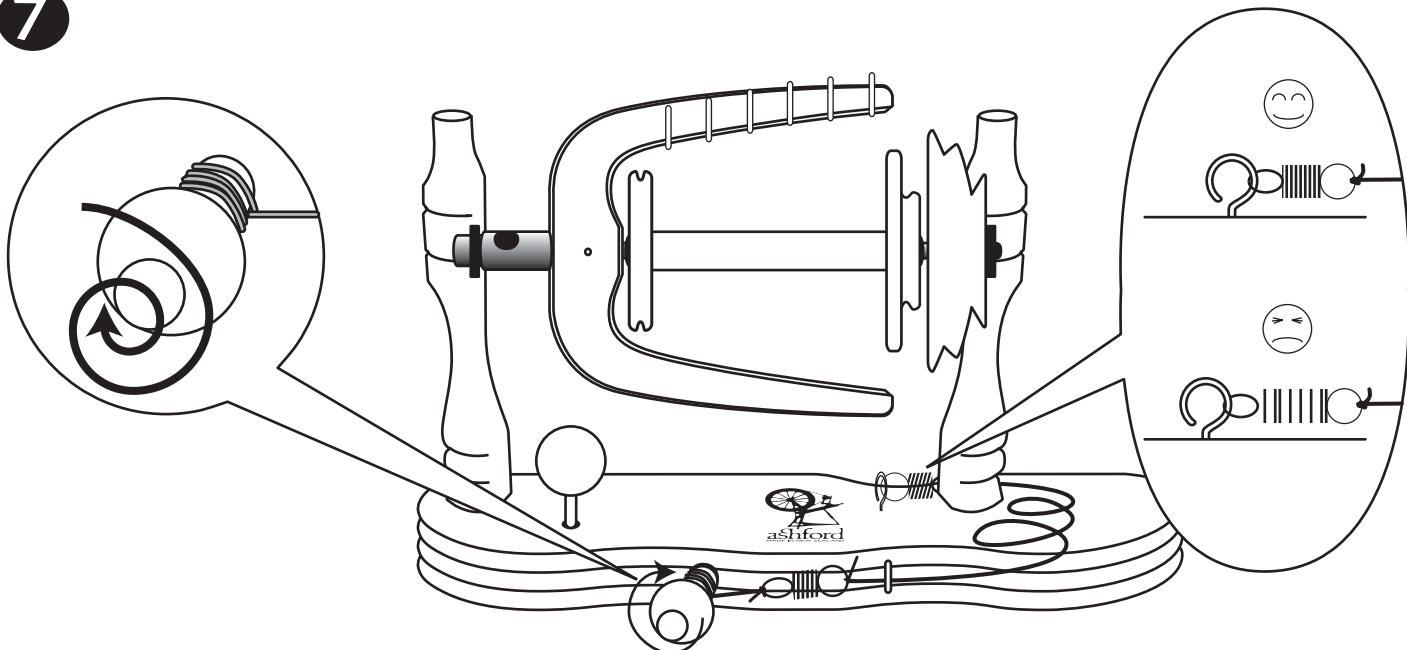

8

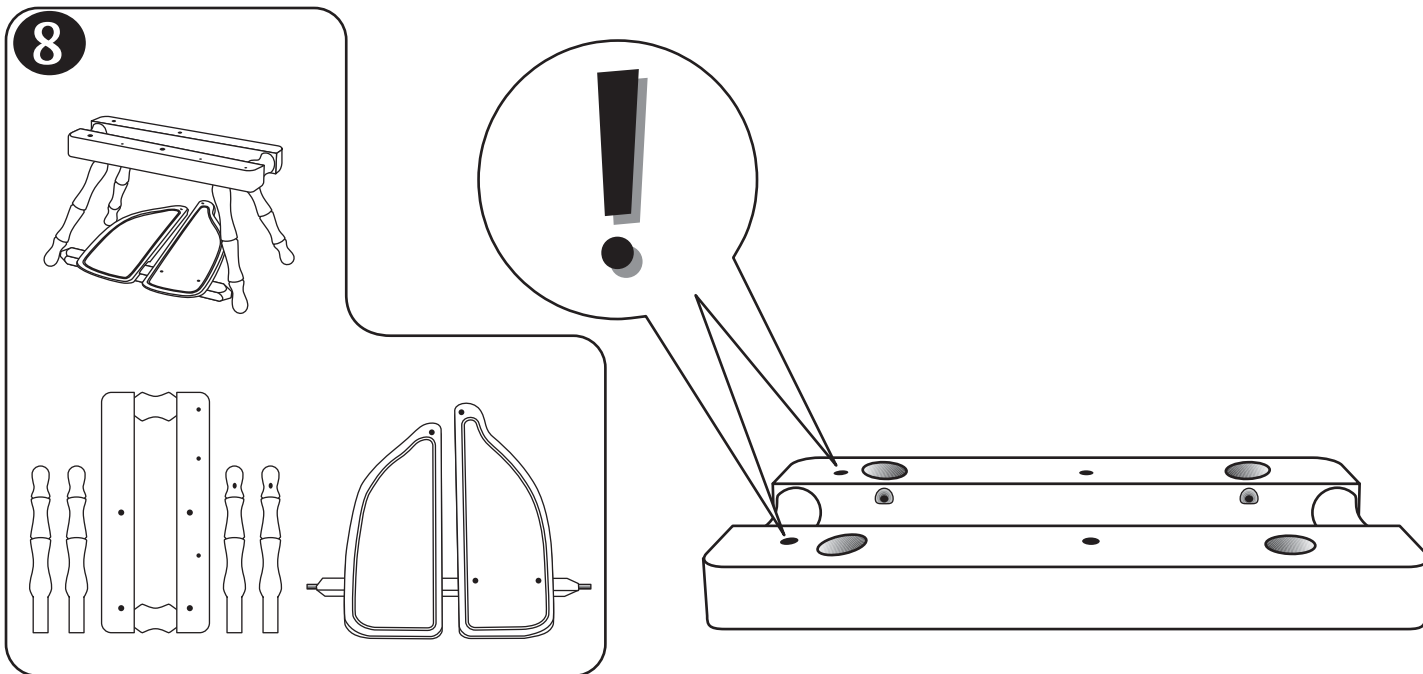

9

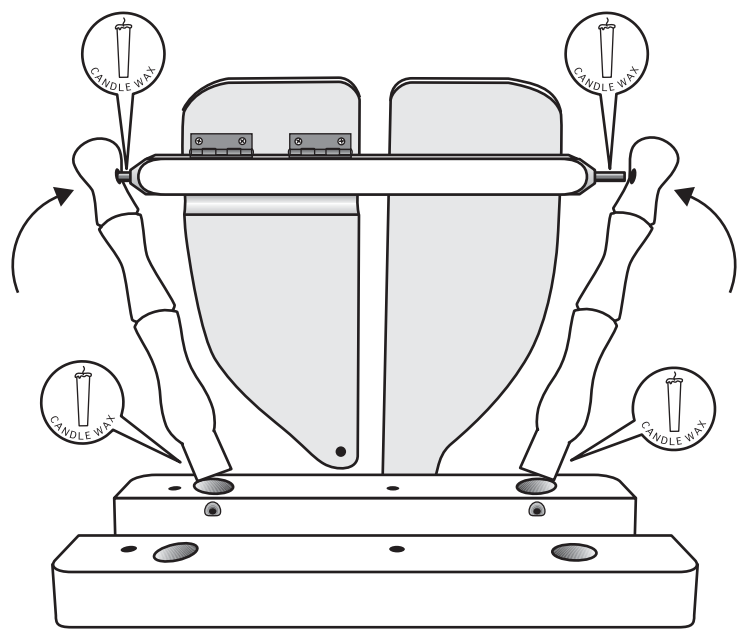

10

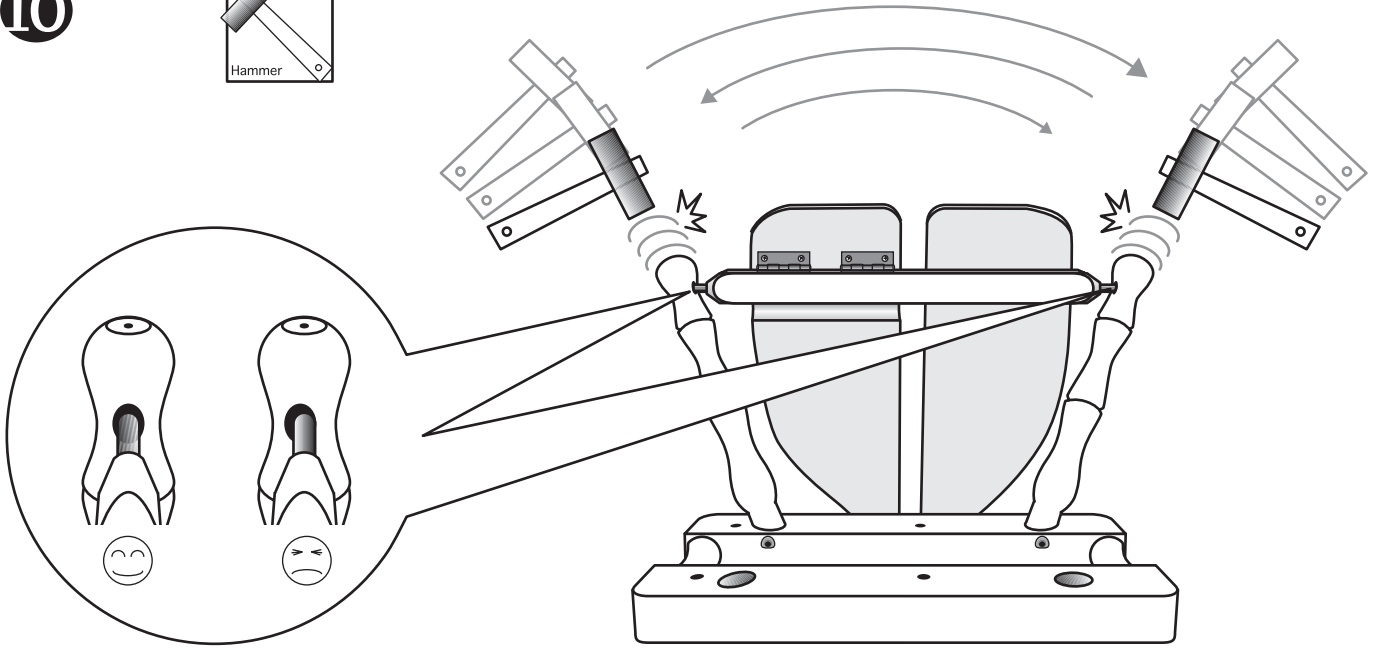
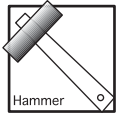

11

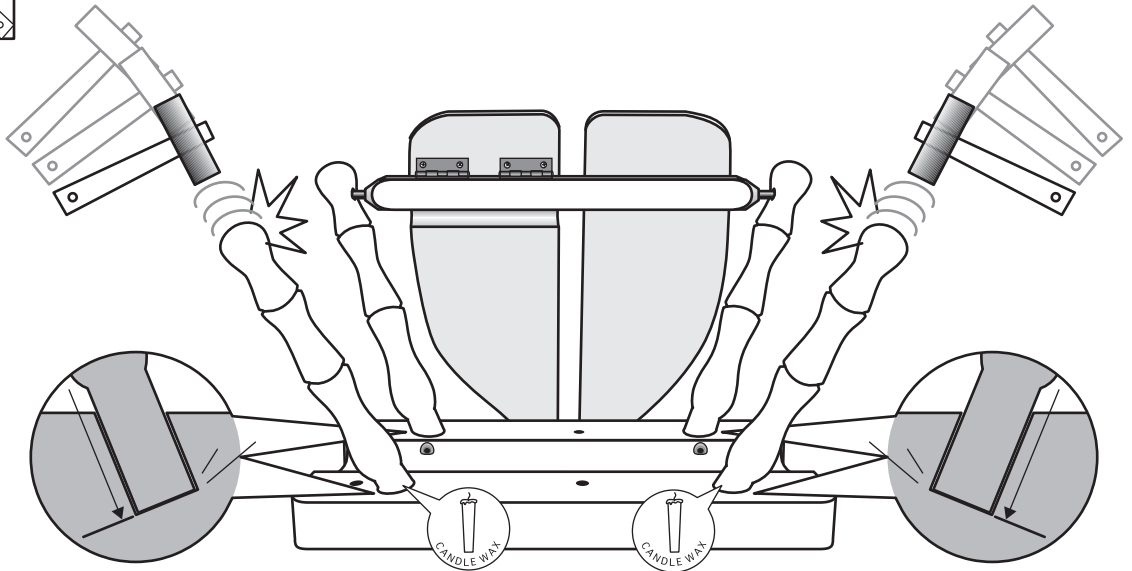
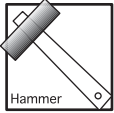

12

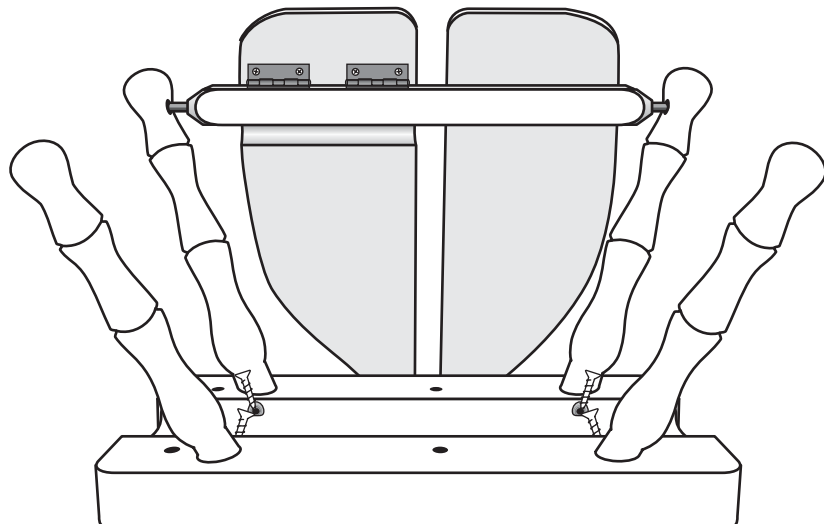
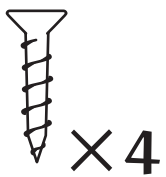

13

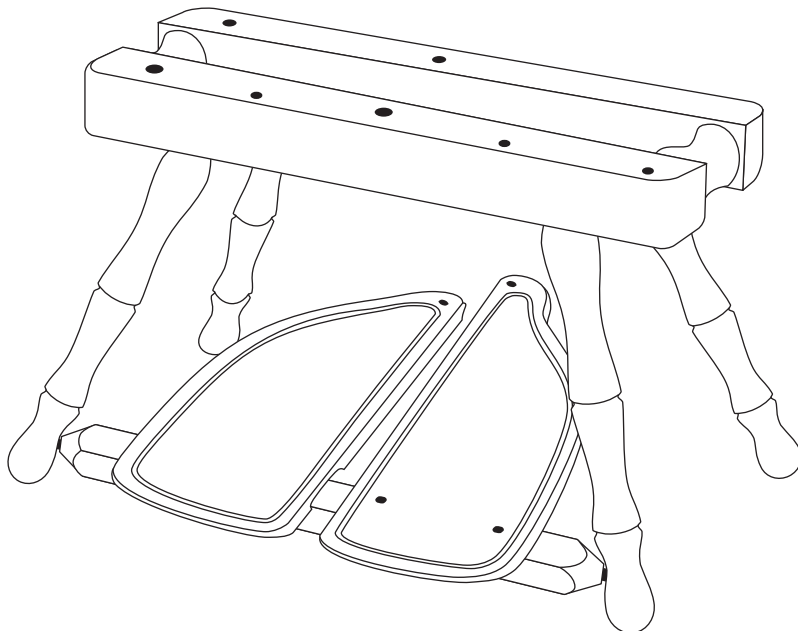

14

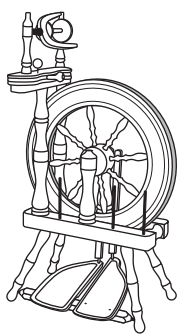

 **check**

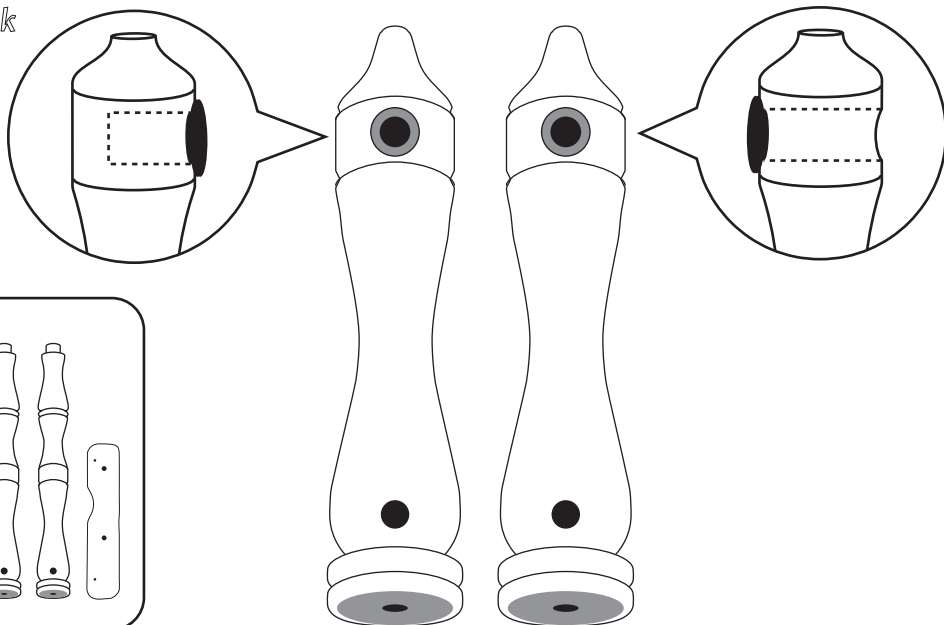

15

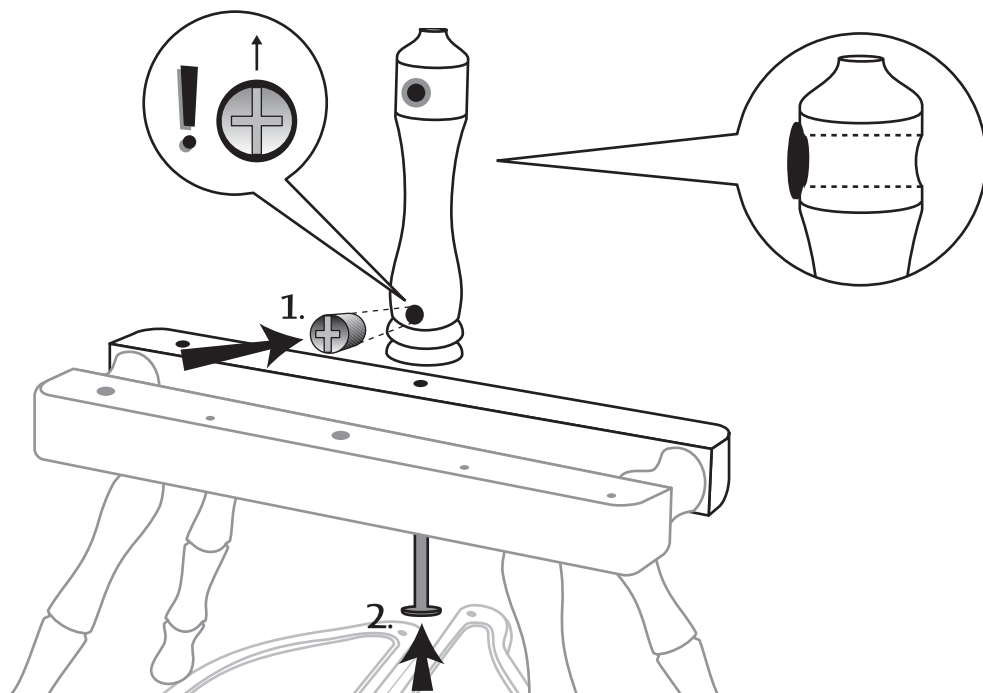
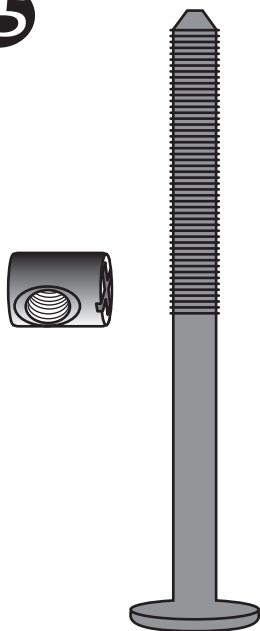

16

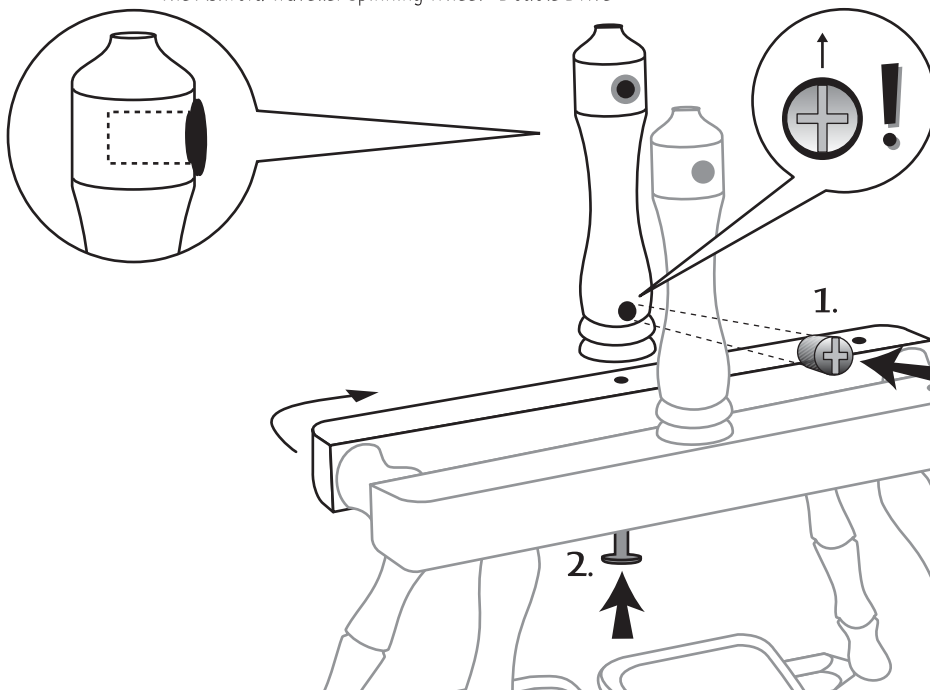
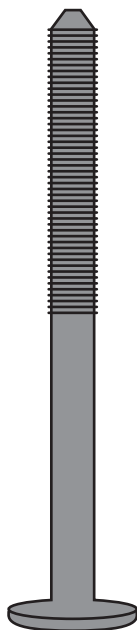

17

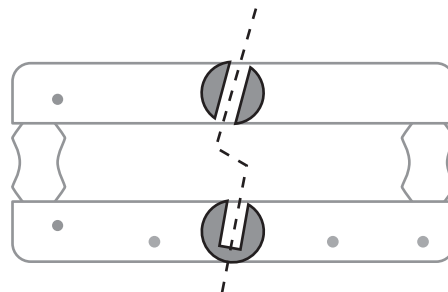
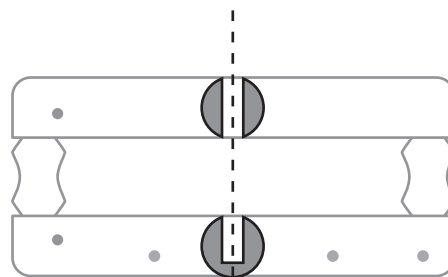
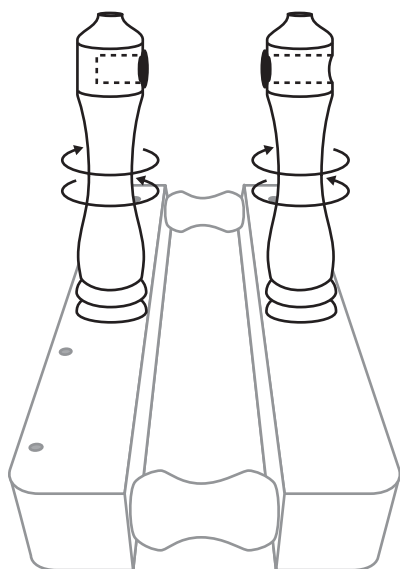

18

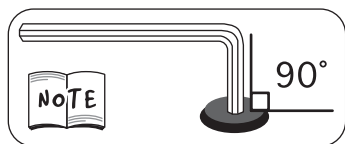
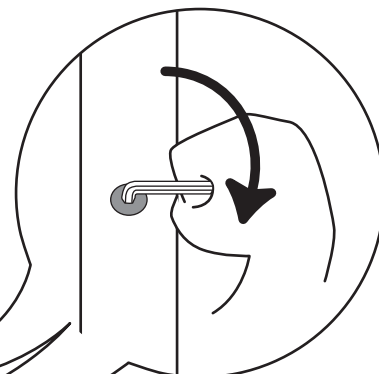
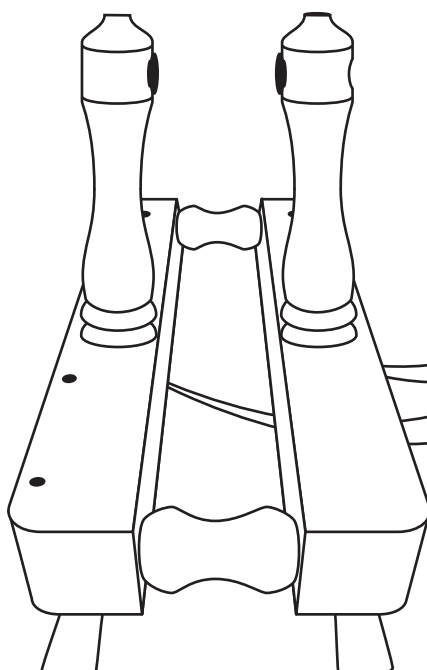

19

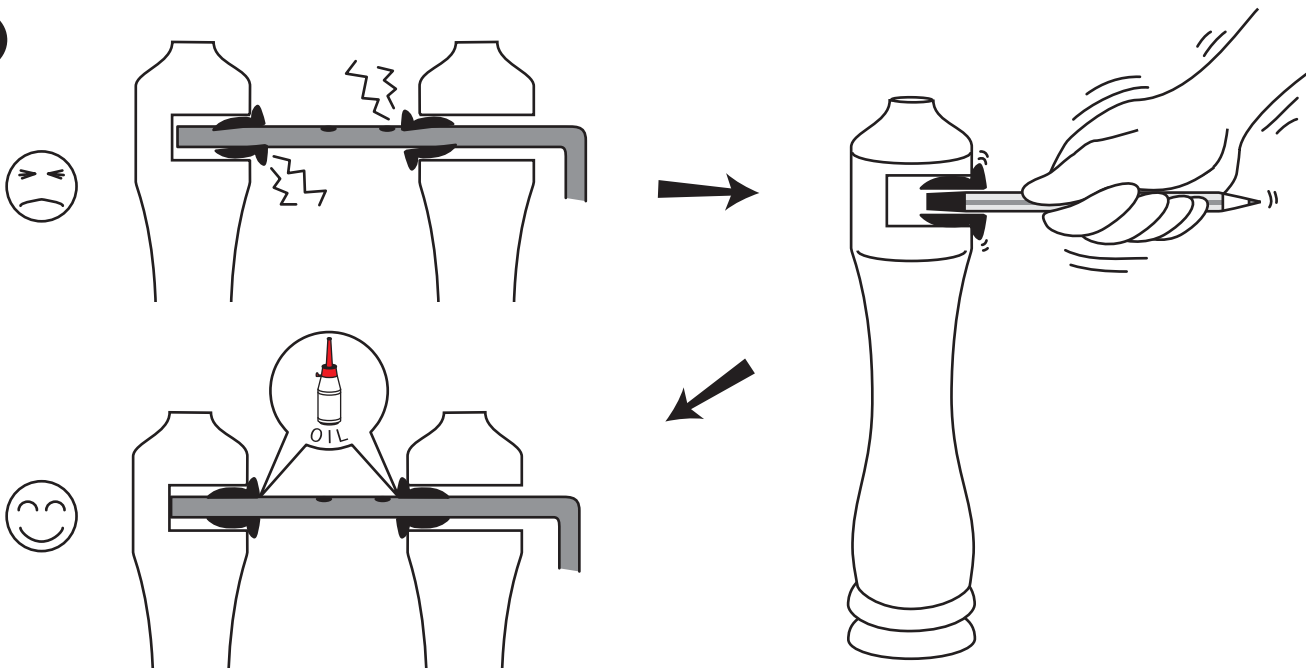

20

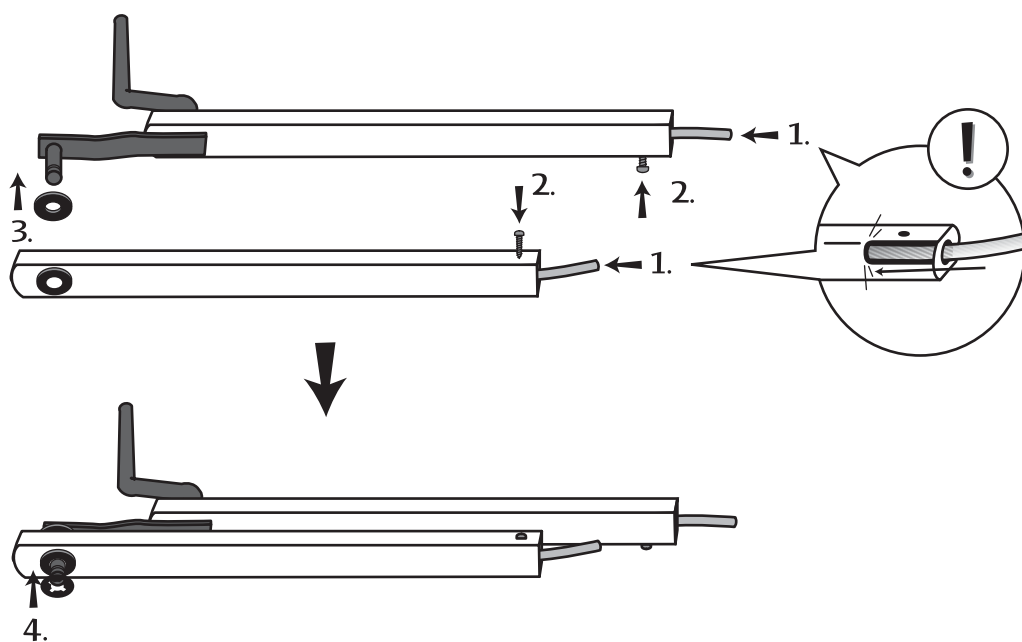
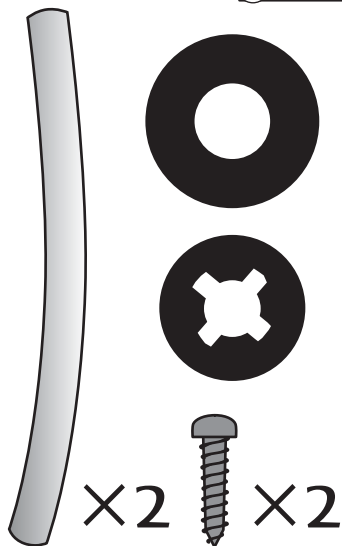

21

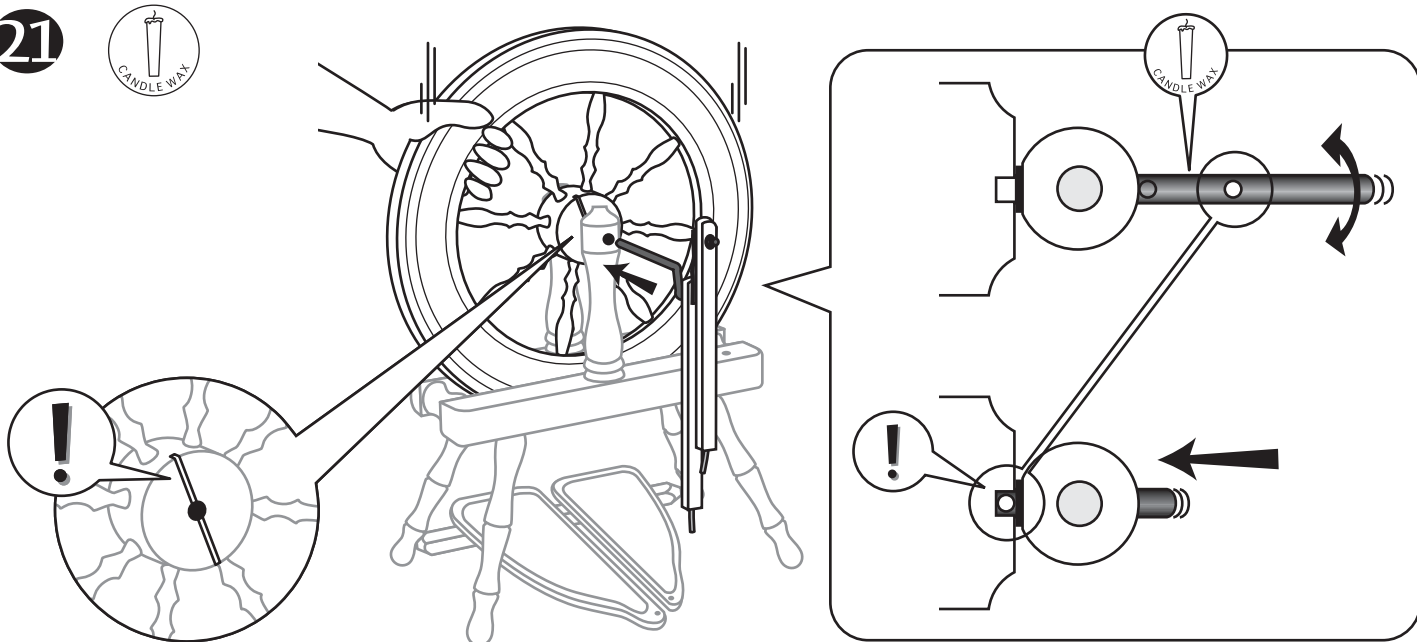

22

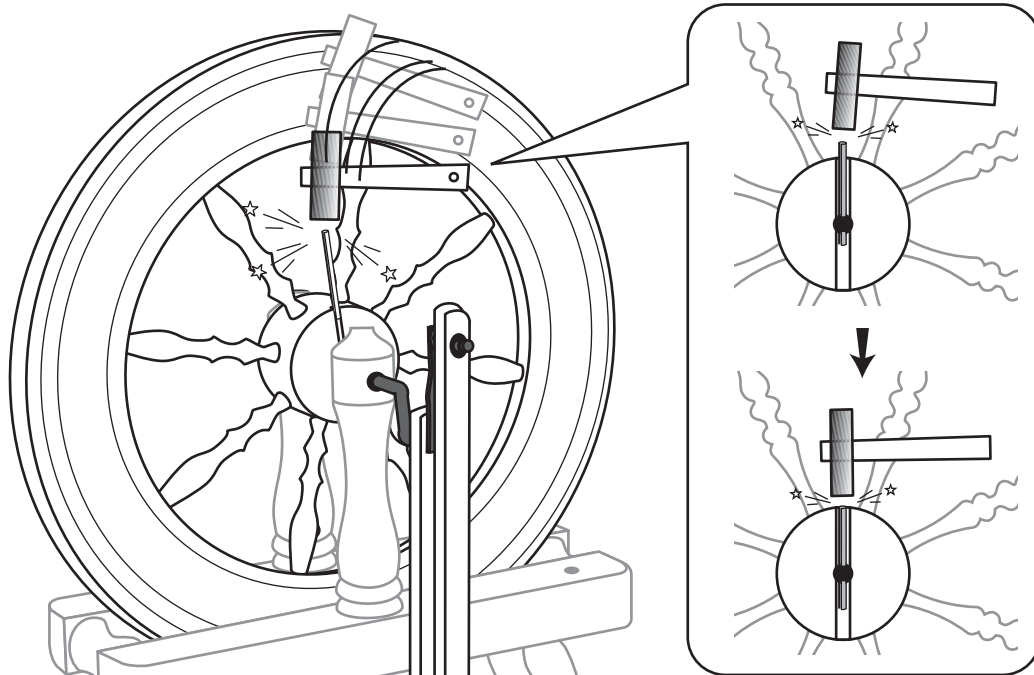
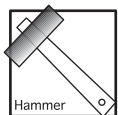

23

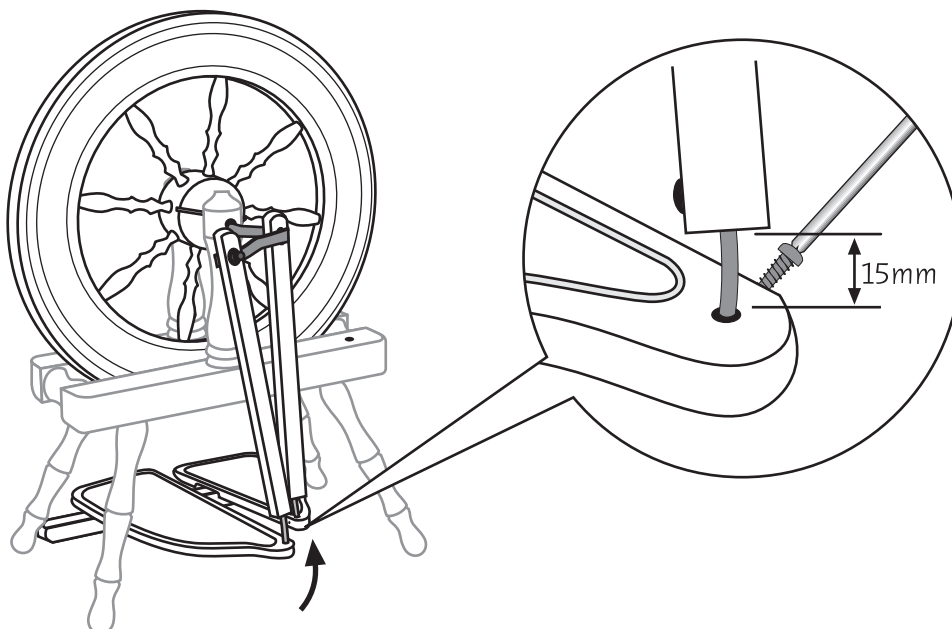
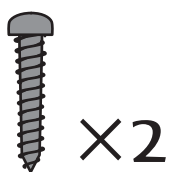
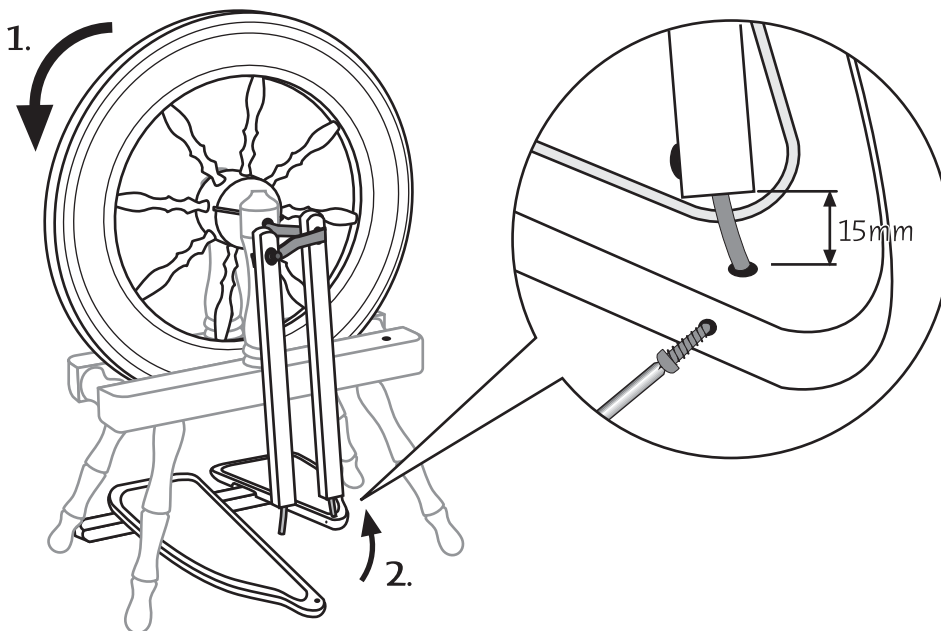

24

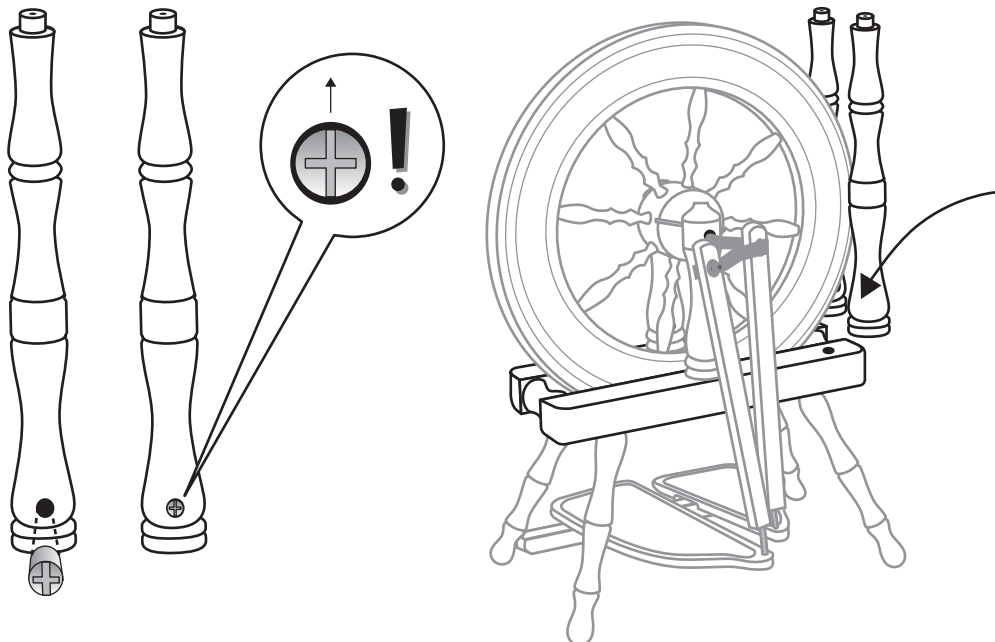

25

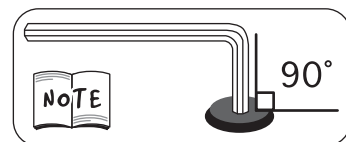
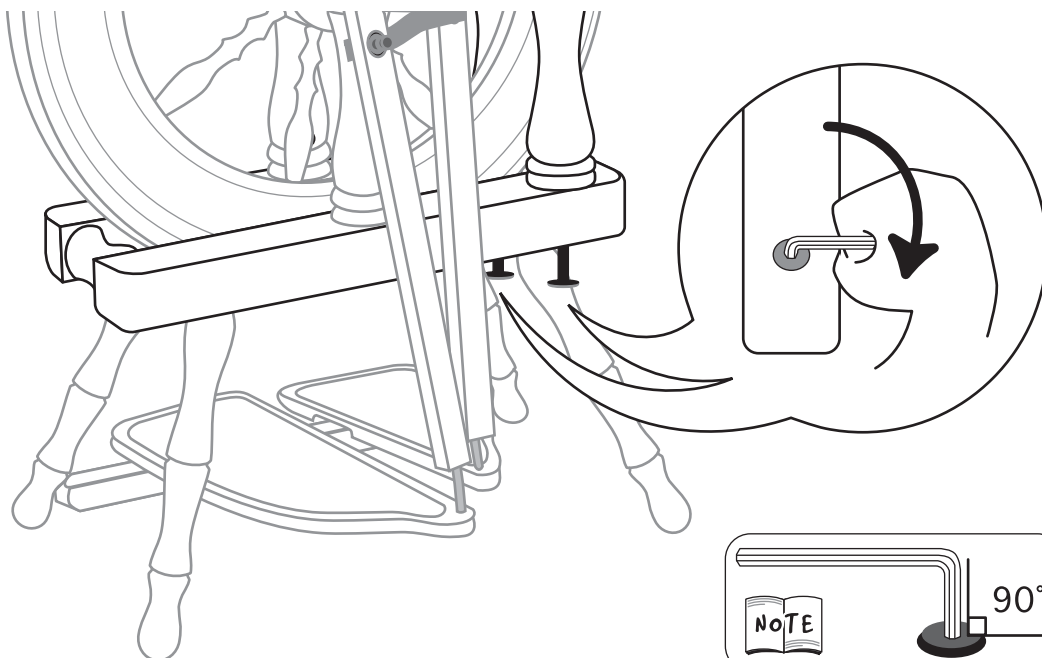
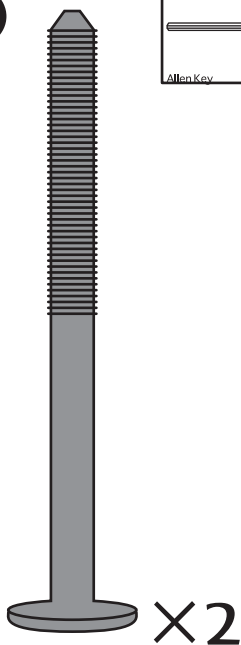

26

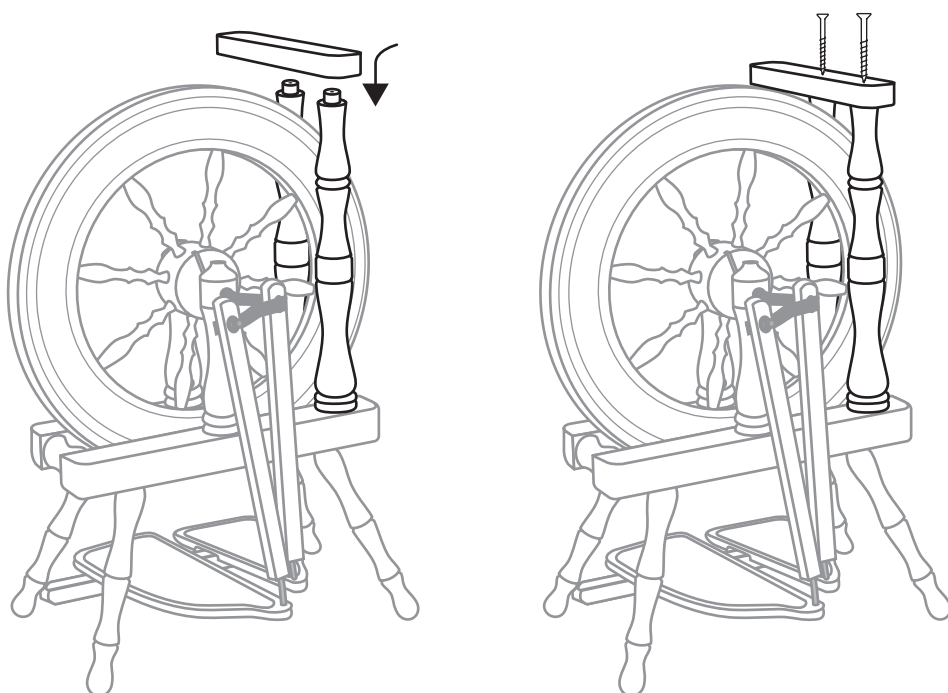
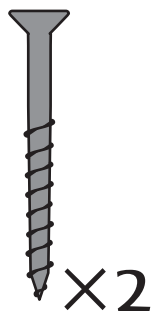

27

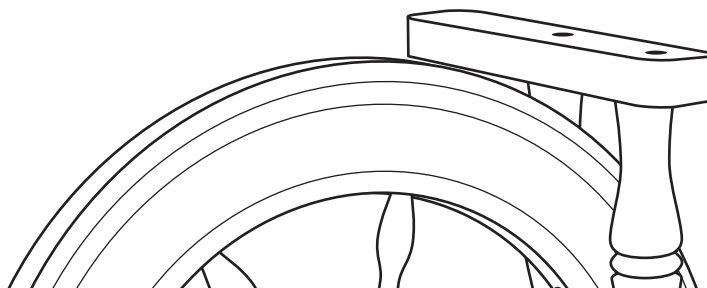
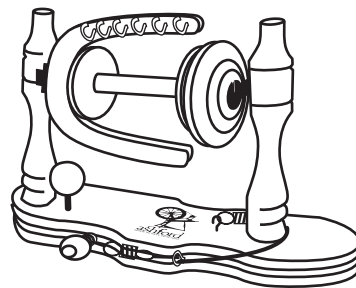

X2

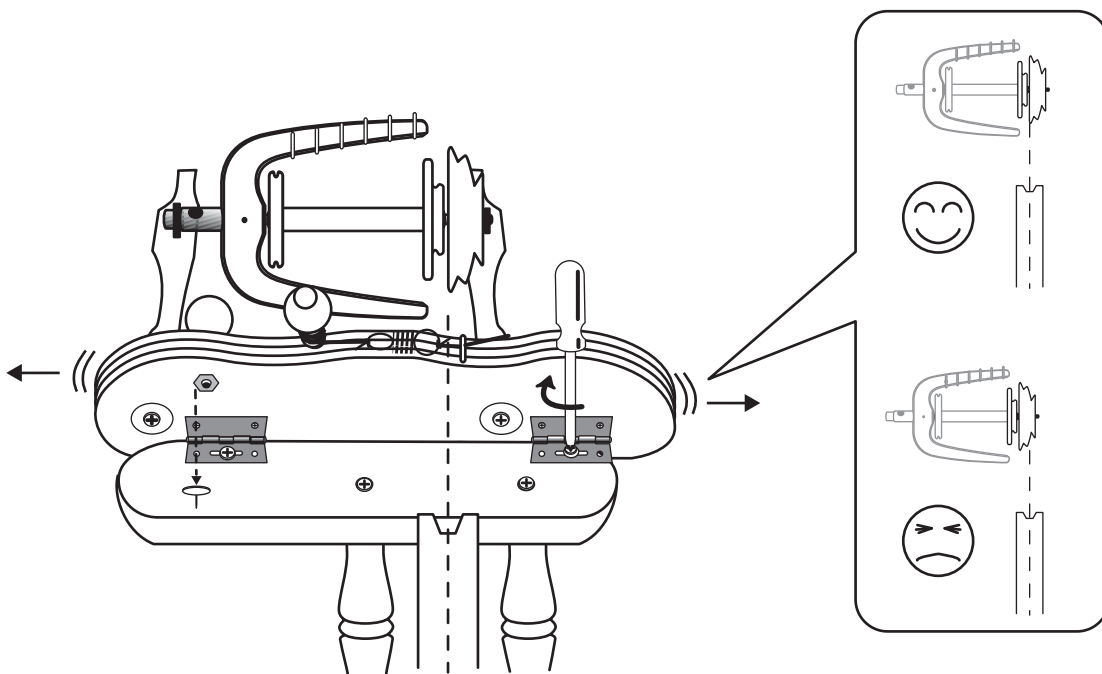

28

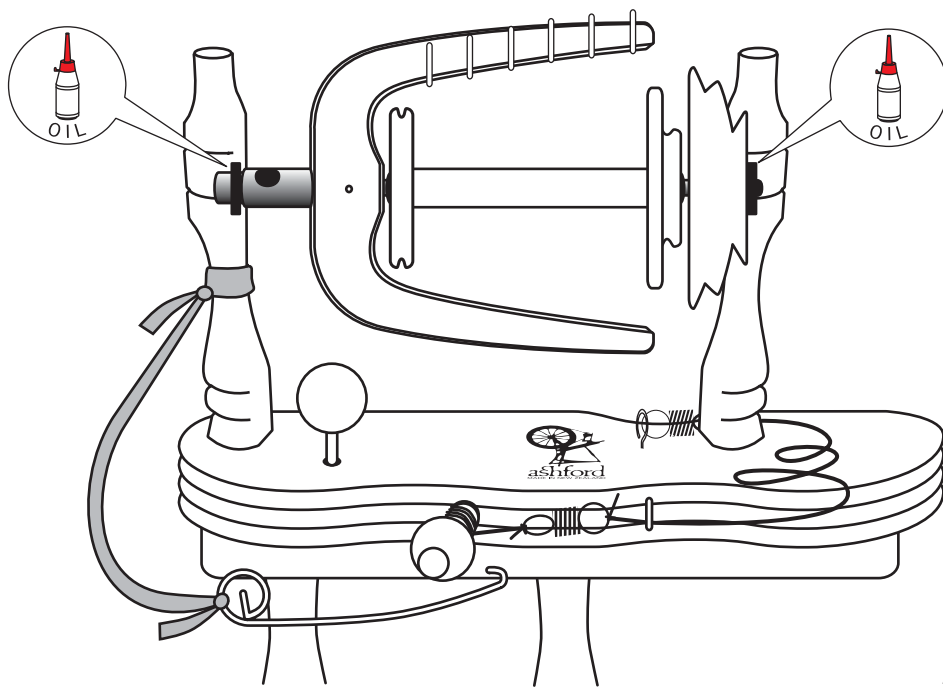

29

NOTE

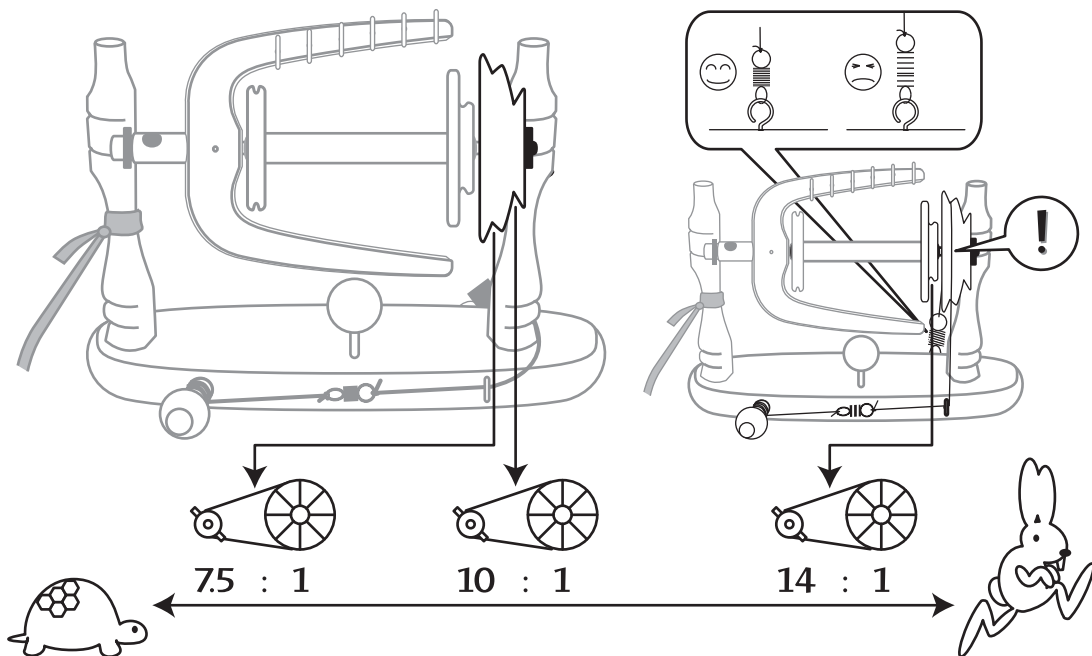

30

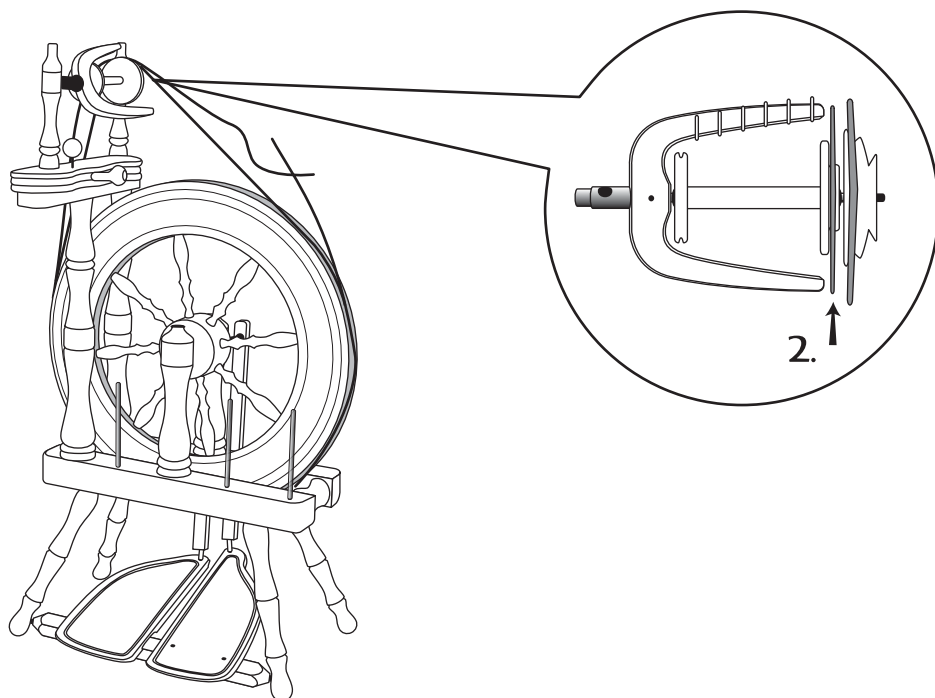
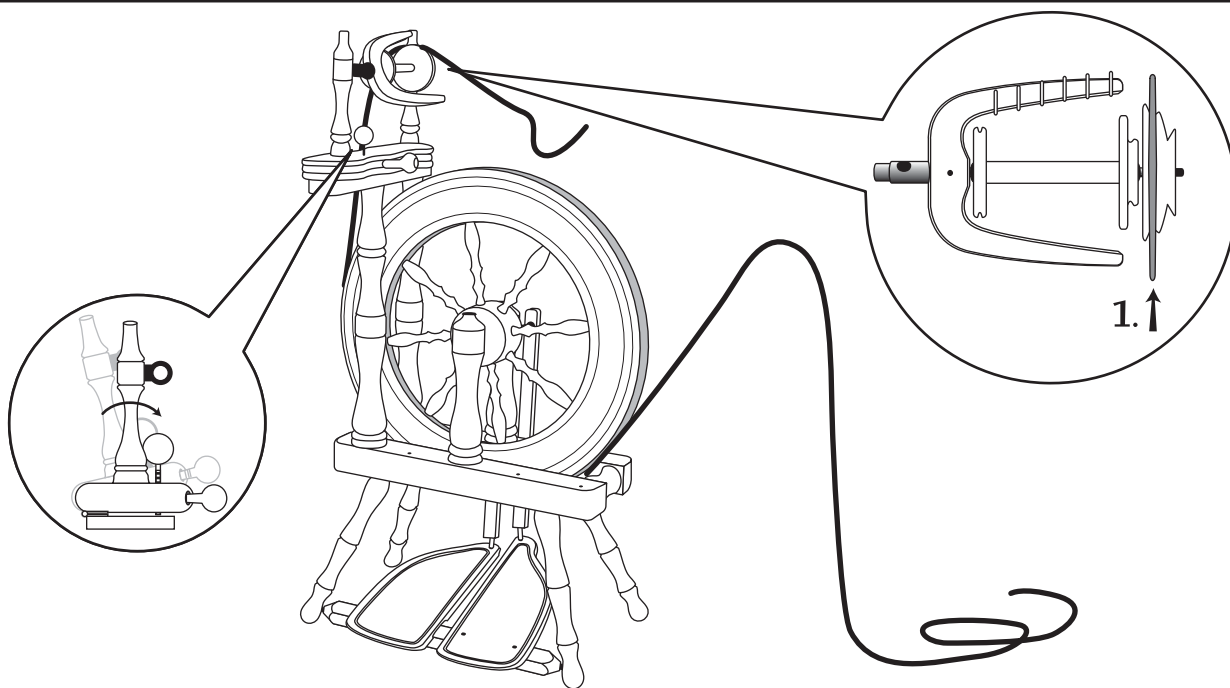

31

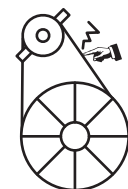
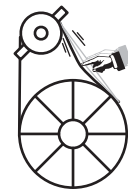
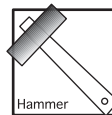
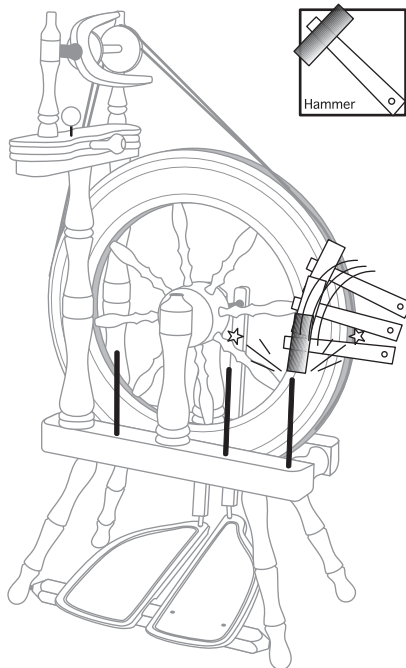
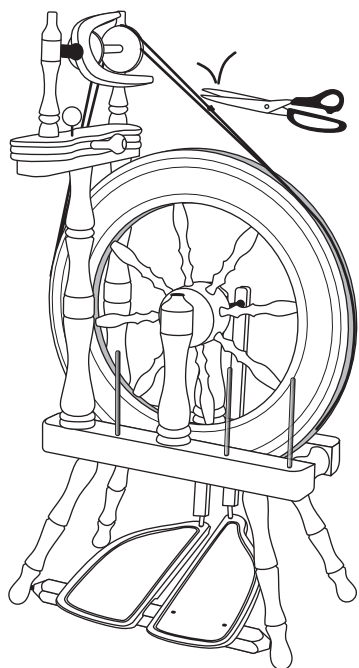

 Check

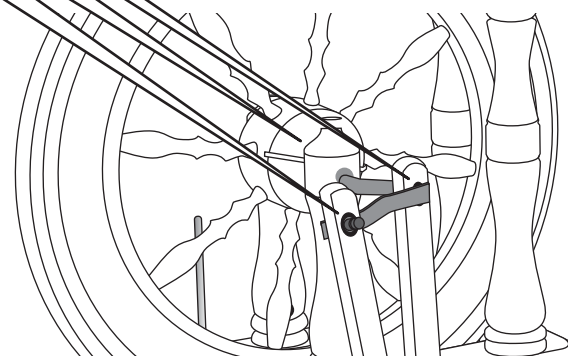
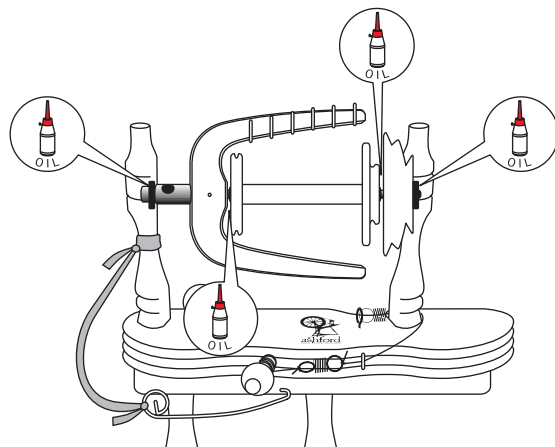
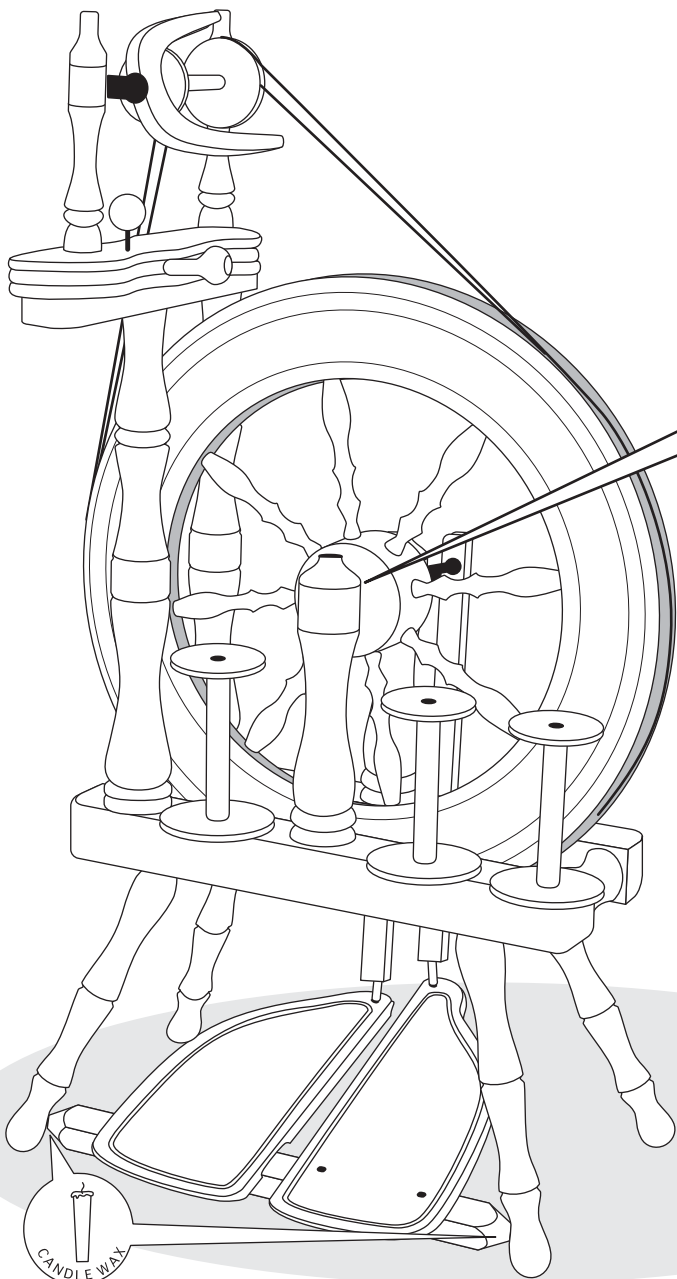



Does not pull yarn in

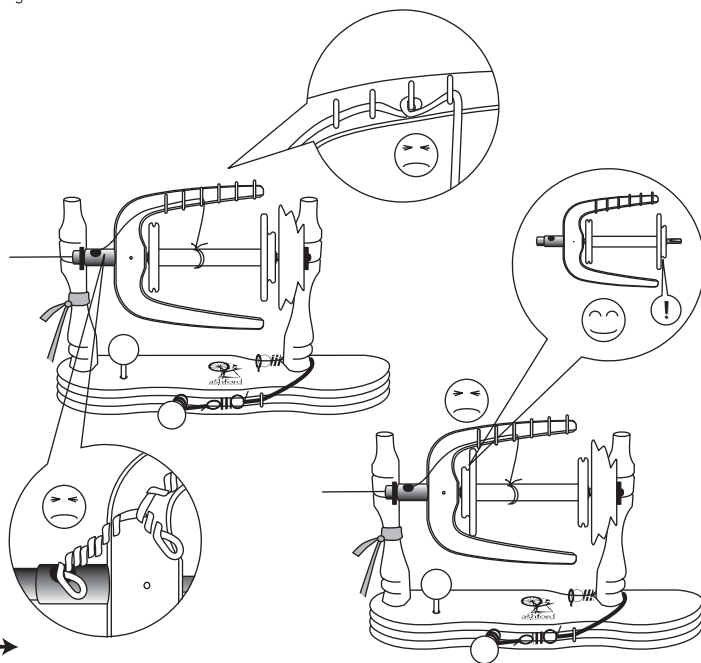
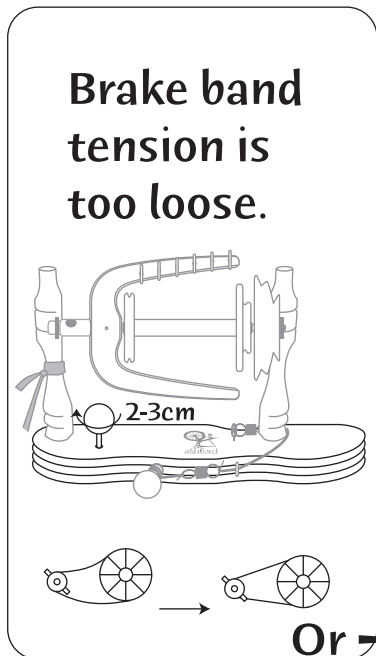

Yarn breaks

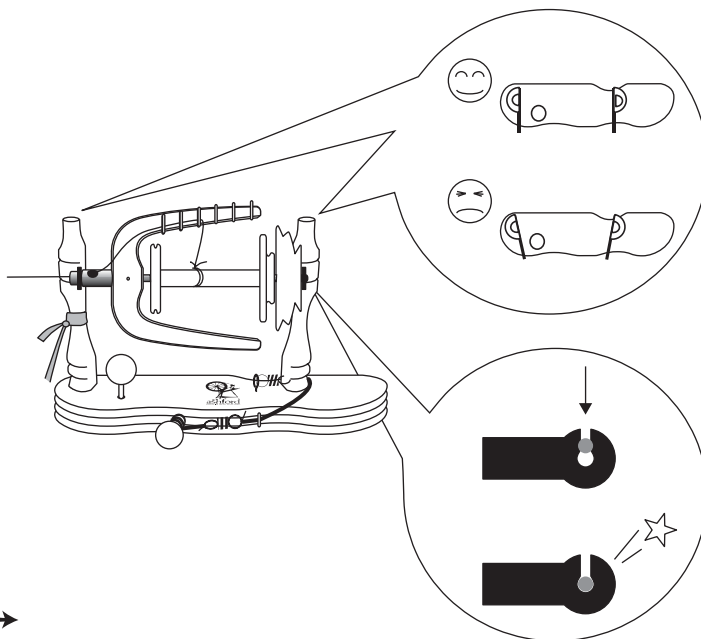
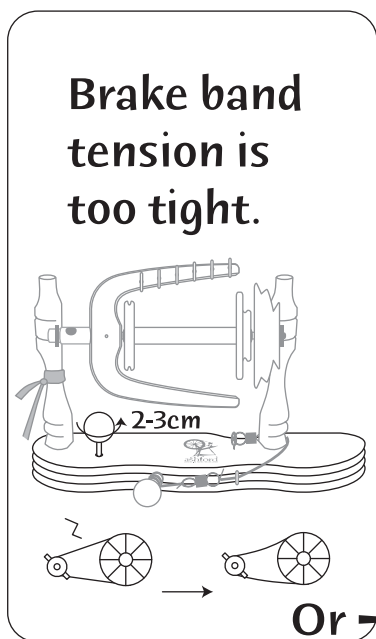

Hard to Treadle

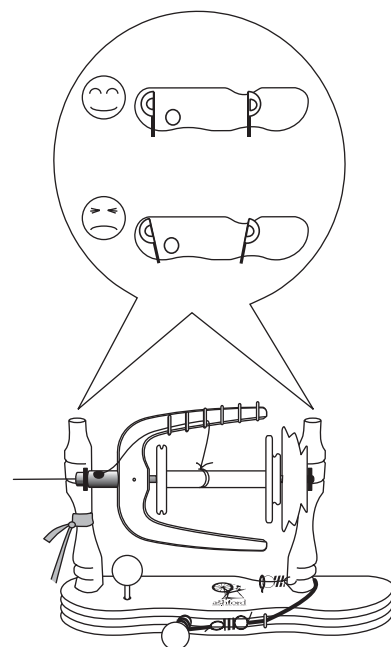
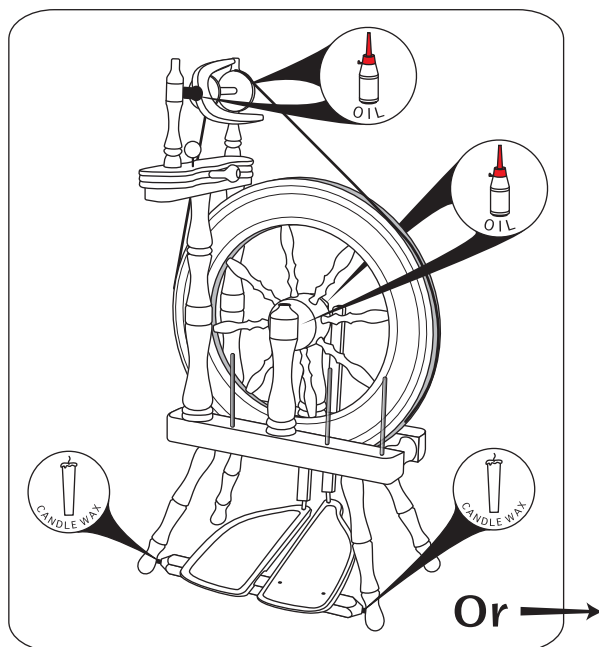

Drive band falls off easily

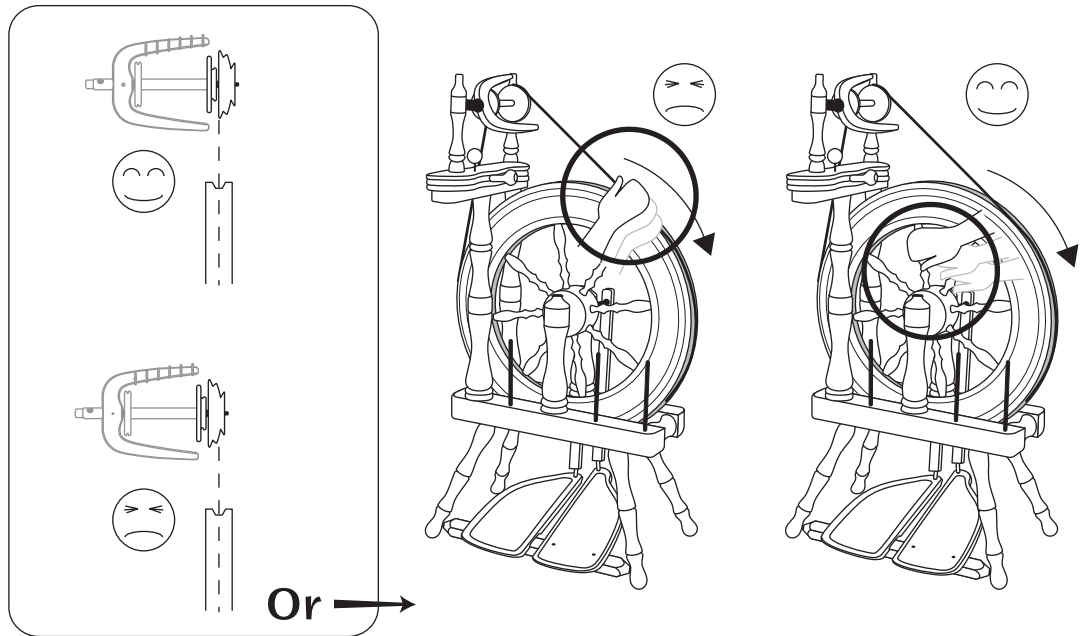

Strange sounds

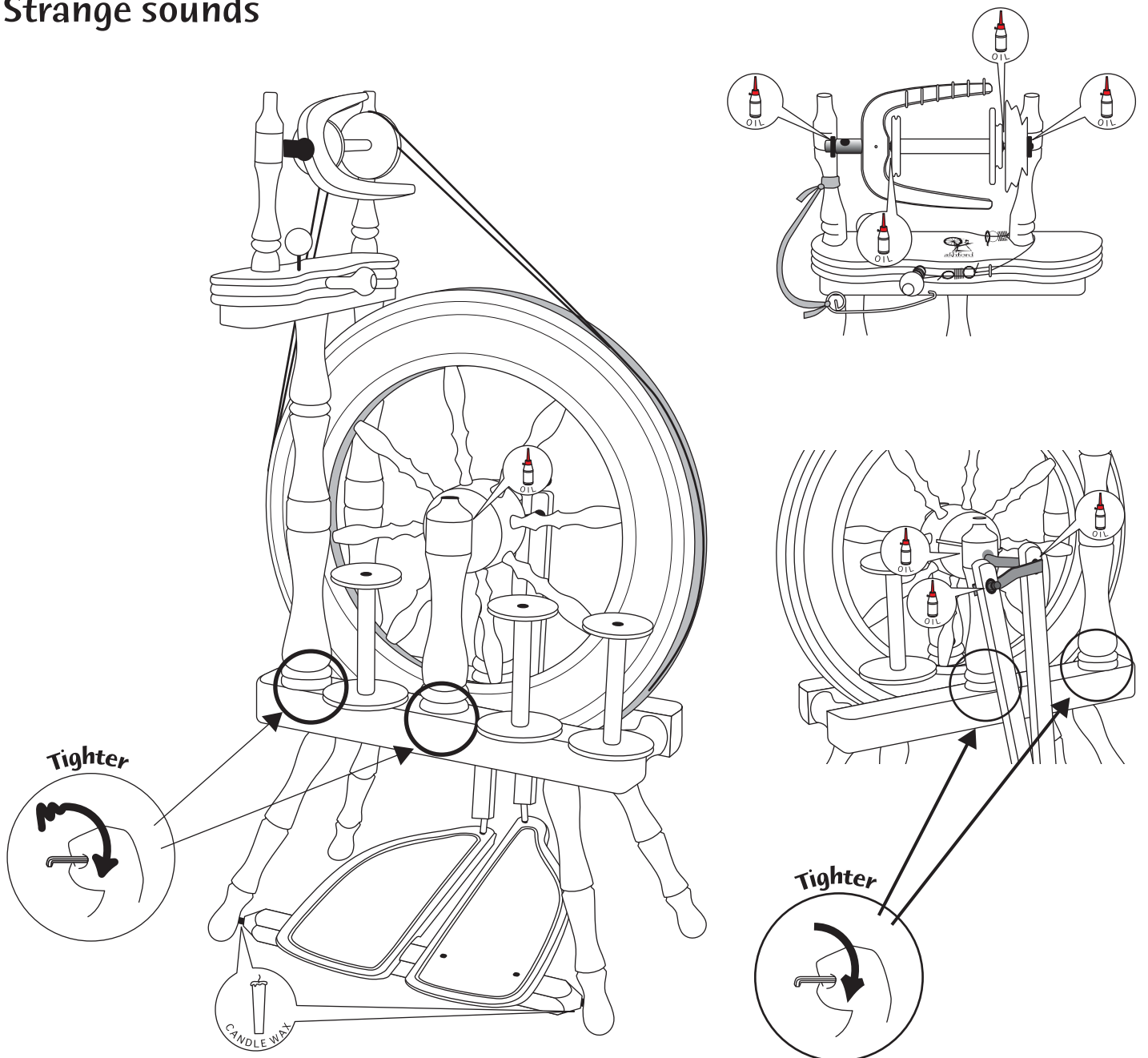

Real Scale Hardware Samples

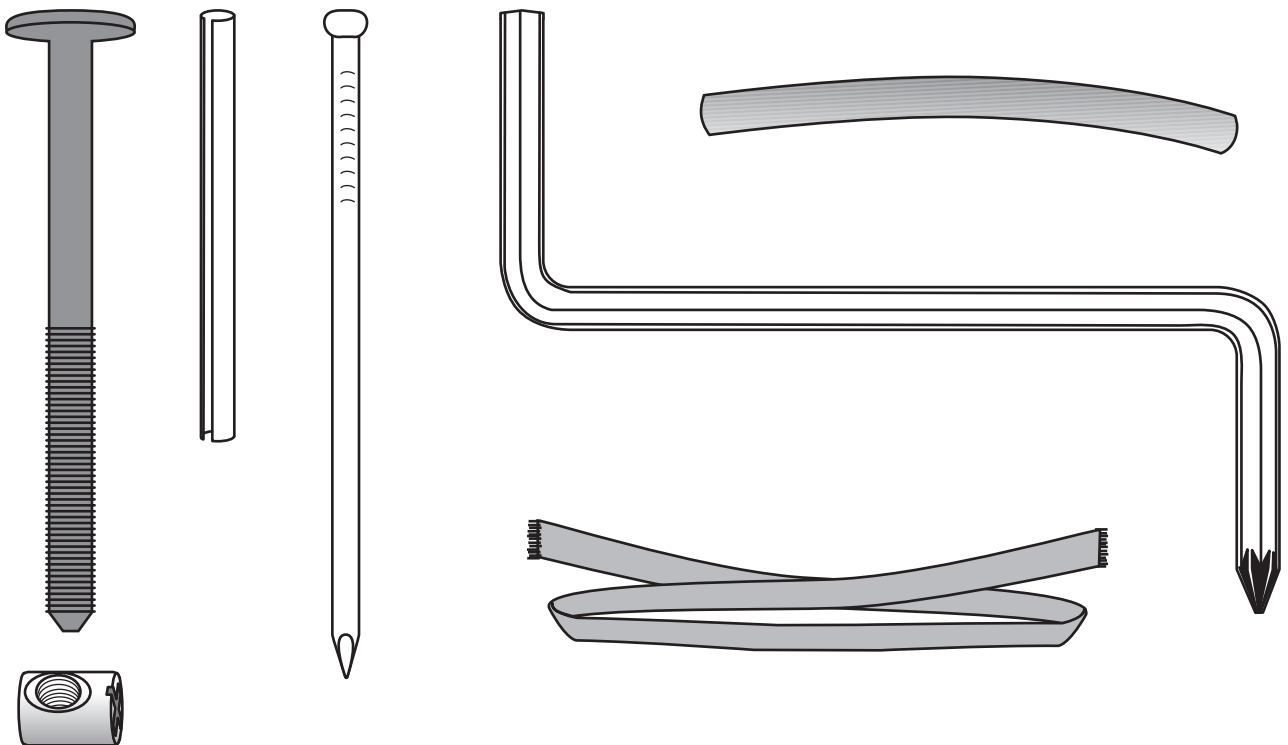
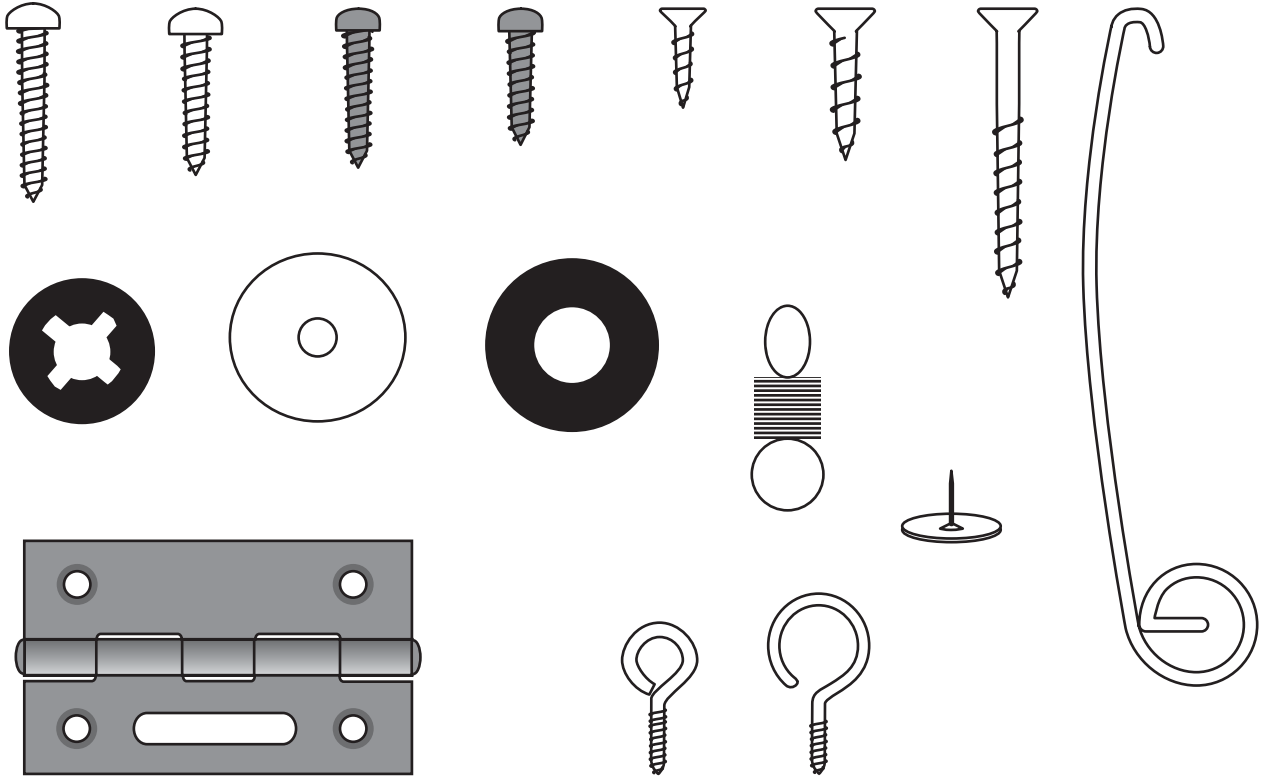

Traveller Double Drive Spinning Wheel - Parts List

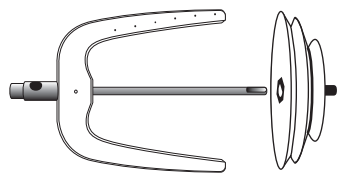

Flyer & Whorl



Maiden Bar

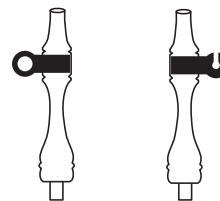

Maid Uprights



Adjusting Knob



Tension Knob

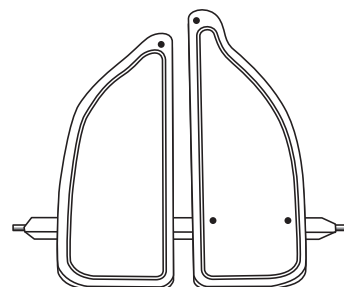

Treadle Assembly

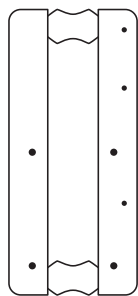

Base

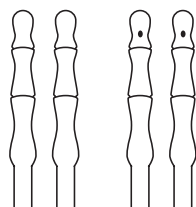

**Legs - 2 with holes
& 2 without**



Wheel Supports

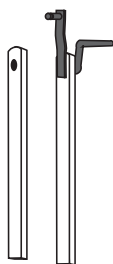

Conrods

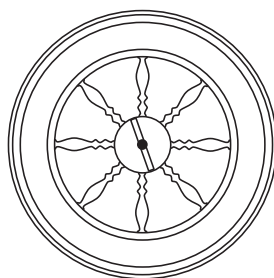

Wheel



Maiden Bar Supports



Top Rail

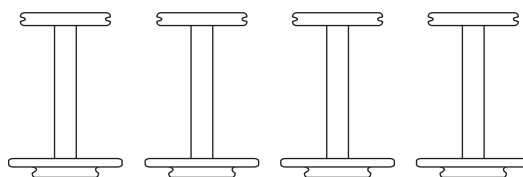

Bobbins

Traveller Double Drive Spinning Wheel - Hardware List

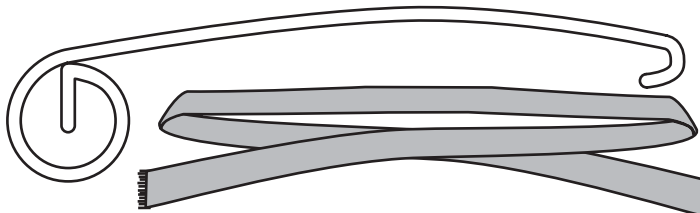

Threader Hook & Tape



1 x Hub Pin

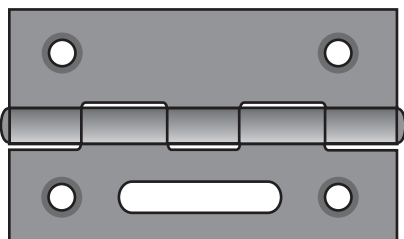

2 x Hinges



3 x Steel Lazy Kate Pins

1 x Double Drive Band
1 x Nylon Brake Band



1 x Drawing Pin

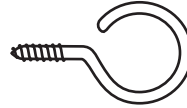

13 x Cup Hooks



1 x Screw Eye



2 x Tension Springs



1 x "O' Clip

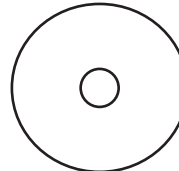

2 x Metal Washer



1 x Nylon Washer

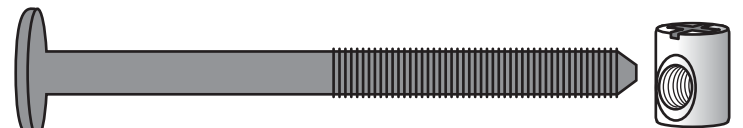

4 x Bolts and Barrell Nuts



2 x Flexible Conrod Joint

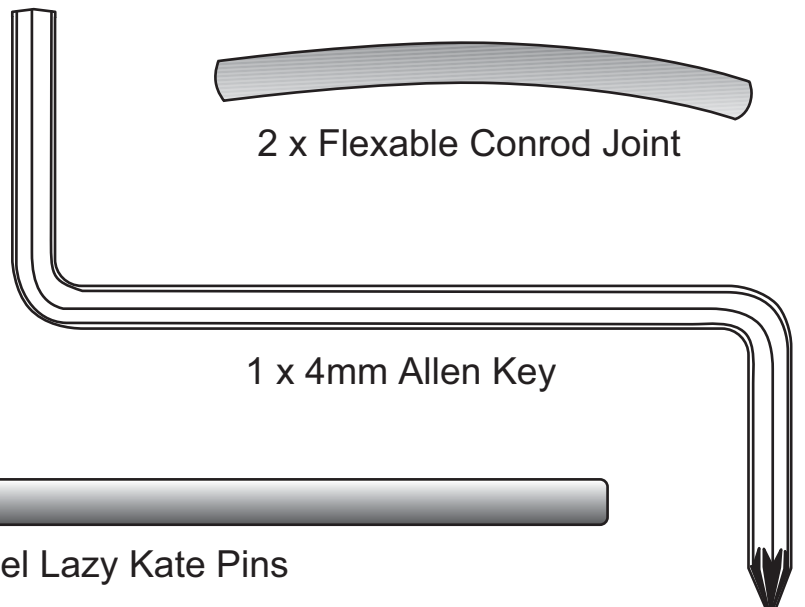

1 x 4mm Allen Key